

REACH-IN FREEZER

Product Specifications

2F - Two Section Freezer Solid Doors, Self-Contained

Units available in one, two and three sections. All upright models contain 3" non-CFC polyurethane foam insulation. Our selection of Reach-In Freezers are available in standard depth, Shallow Depth, Slim Line and Extra Wide models.



ENERGY STAR® Qualified Commercial Freezer

OPTIONS AND ACCESSORIES

- | | |
|---|--|
| • Stainless steel case back | • Adjustable Legs |
| • Pan slide assemblies | • Half doors |
| • Increased refrigeration systems | • Pass-Thru |
| • Stainless steel shelves | • Remote models |
| • Digital thermometer | • Shallow-Depth |
| • Rehinging of doors (<i>consult factory</i>) | • Hinged glass doors |
| • Expansion valve system | • Special electrical requirements (<i>consult factory</i>) |

Consult factory for other model configurations, options and accessories.

Continental
Refrigerator

Toll-Free: 800-523-7138
Phone: 215-244-1400
Fax: 215-244-9579

539 Dunksferry Road
Bensalem, PA 19020
www.continentalrefrigerator.com

DIMENSIONAL DATA

Net Capacity (cu. ft.)	48 (1359 cu l)
Width, Overall (in.)	52 (1321 mm)
Depth, Overall (incl. handles) (in.)	35 ³ / ₈ (899 mm)
Depth [less door(s)] (in.)	32 (813 mm)
Depth [door(s) open 90°] (in.)	55 ¹ / ₂ (1410 mm)
Clear Door Width (in.)	19 ³ / ₈ (492 mm)
Clear Full Door Height. (in.)	58 ⁵ / ₈ (1489 mm)
Clear Half Door Height. (in.)	27 ¹ / ₂ (699 mm)
Height, Overall (incl. 5" casters) (in.)	82 ¹ / ₄ (2089 mm)
No. of Full Door(s)	2
No. of Half Door(s)	4
No. of Shelves	6
Shelf Area (sq. ft.)	40.8 (3.8 sq m)
Tray Slide Capacity (per half section)	8 ea.
Tray Slide Capacity (per full section)	16 ea.

REFRIGERANT DATA

Condensing Unit Size (H.P.)	1/2
Capacity (BTU/Hr)*	2470

ELECTRICAL DATA

Cabinet	115/60/1
Feed Wires (incl. ground)	3
Condensing Unit	115/60/1
Total Amps	9.8
Cabinet Amps	1.9
Defrost Amps	6.5

SHIPPING DATA

Height - Crated (in.)	85 ¹ / ₂ (2172 mm)
Width - Crated (in.)	64 (1626 mm)
Depth - Crated (in.)	42 (1067 mm)
Volume - crated (cu. ft.)	133 (3766 cu l)
Weight Standard - Crated (lbs.)	555 (252 kg)
Weight SS - Crated (lbs.)	635 (288 kg)
Weight Standard - Uncrated (lbs.)	385 (175 kg)
Weight SS - Uncrated (lbs.)	465 (211 kg)

* Rating @ -15°F evaporator, 90°F ambient
Figures in parentheses reflect metric equivalents.

IMPORTANT NOTE: If the cabinet is located directly against a wall and/or under a low ceiling, a **minimum clearance of 12"** is required.

Project Name:

Model Specified:

Location:

Item No:

Quantity:

APPROVAL:

Standard Design Features

REFRIGERATION SYSTEM

Environmentally-safe R-404A refrigerant

CABINET ARCHITECTURE

3" non-CFC polyurethane foam insulation

Chrome-plated flow line handles

Cam action, lift off hinges

Self-closing doors

Magnetic snap-in door gasket

Cylinder lock in each door

5" casters

Heavy-duty epoxy-coated steel shelves

MODEL FEATURES

Automatic interior lighting

Exterior dial thermometer

Automatic, energy-saving, electric condensate evaporator

Automatic electric defrost

Energy saving switch for door heaters

ELECTRICAL

Completely pre-wired at factory for connection to 115/60/1 phase, 15 amp dedicated outlet

10 ft. cord and plug set included, 90° plug

STANDARD

Stainless steel front, aluminum end panels and interior

SUFFIX SA

Stainless steel exterior, aluminum interior

SUFFIX SS

Stainless steel exterior and interior



Equipped with one NEMA-5-15P Plug



This Continental Refrigerator product is warranted to be free from all manufacturing defects, material or workmanship, for a period of one (1) year from date of original installation, or fifteen (15) months from date of shipment, whichever occurs first. All motor-compressor assemblies are warranted to be free from defects, material and workmanship, for a period of five (5) years from date of installation.

Due to our continued efforts in developing innovative products, specifications subject to change without notice.



© Copyright 2011. Continental Refrigerator.
A Division of National Refrigeration & Air Conditioning Products, Inc.

REACH-IN FREEZER

2F - Two Section Freezer Model Blueprint

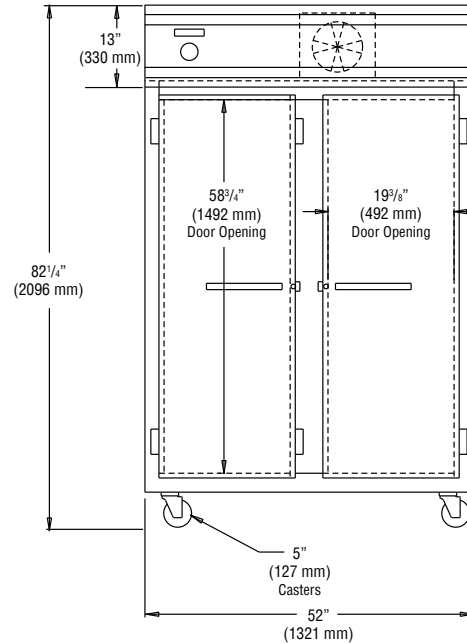

FRONT VIEW

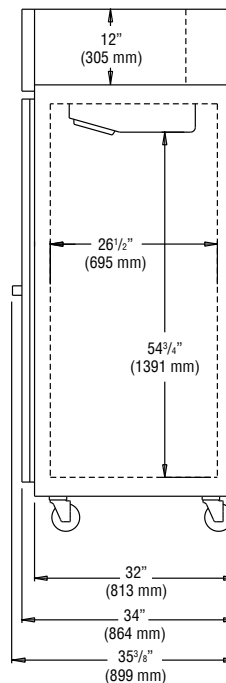

SIDE VIEW

Continental

Refrigerator

Toll-Free: 800-523-7138
Phone: 215-244-1400
Fax: 215-244-9579

539 Dunksferry Road
Bensalem, PA 19020
www.continentalrefrigerator.com

2F (5/10/11)